

# Double Pitch Chain

## 더블피치 체인

- \* Dong Bo Double Pitch Chain conform to ANSI and manufactured in <Environment Resistant Chain Series > as are single pitch chain.
- \* Heavy side plates are used for 2060H, 2062H and up

- \* 더블피치 체인은 링크플레이트의 피치가 표준형 로울러 체인의 2배인 체인으로 저속이면서 긴 축간 거리의 컨베이어 라인에 적합한 체인입니다.
- \* 링크플레이트를 제외한 부품은 표준형 로울러체인 (ANSI타입)과 동일합니다.
- \* 2060이상은 강력형(H)으로 제작됩니다.

### Type-A

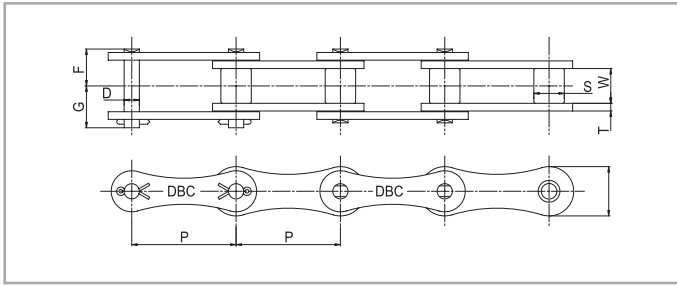

### Type-C

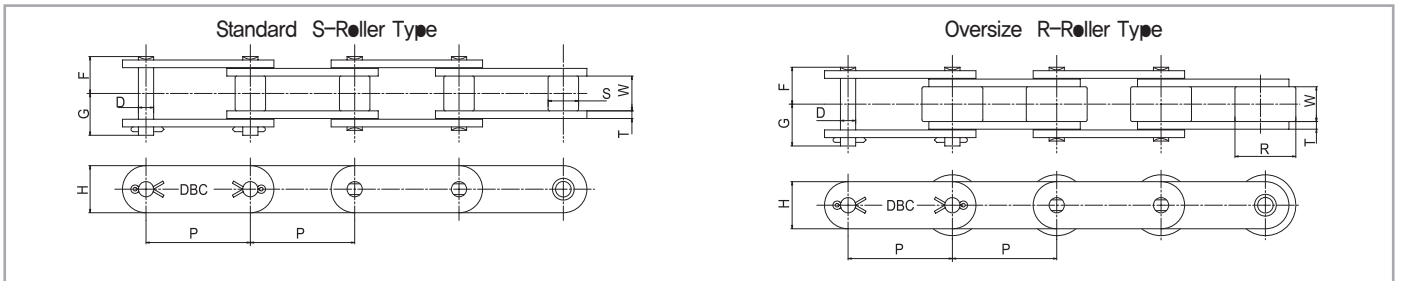

## Double Pitch Chain : Example of type indication

### 더블피치 체인 : 체인 호칭번호 설명

**DBC A 2082 H A-2 2L**

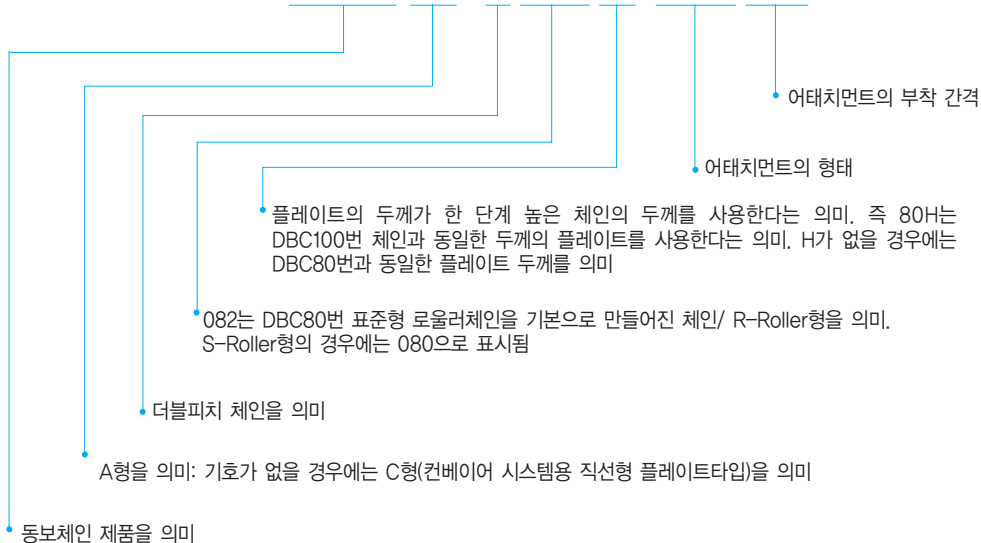



## Double Pitch Chain

### 더블피치 체인

DONG BO Chain No.	Pitch	Inner Width	Roller Dia S-Roller	Roller Dia R-Roller	Pin			Plate		Avg Breaking Load	max Allowable Load	Approx. Weight
	P	W min	S max	R	F	G	D max	T	H max	kgf	kgf	kg/m

#### Type-A

unit : mm

<b>DBC A2040</b>	25.40	7.95	7.94	-	8.25	9.95	3.97	1.5	12.0	1,700	270	0.40
<b>DBC A2050</b>	31.75	9.53	10.16	-	10.30	12.00	5.09	2.0	15.0	2,800	450	0.66
<b>DBC A2060</b>	38.10	12.70	11.91	-	12.85	14.75	5.96	2.4	18.0	4,100	660	0.96
<b>DBC A2080</b>	50.80	15.88	15.88	-	16.25	19.25	7.94	3.2	24.1	7,000	1,150	1.73
<b>DBC A2100</b>	63.50	19.05	19.05	-	19.75	22.85	9.54	4.0	30.1	11,000	1,900	2.57
<b>DBC A2120</b>	76.20	25.40	22.23	-	24.90	28.90	11.11	4.8	36.2	15,400	2,600	3.68

#### Type-C

<b>DBC C2040</b>	25.40	7.95	7.94	-	8.25	9.95	3.97	1.5	12.0	1,700	270	0.51
<b>DBC C2042</b>			-	15.88								0.87
<b>DBC C2050</b>	31.75	9.53	10.16	-	10.30	12.00	5.09	2.0	15.0	2,800	450	0.84
<b>DBC C2052</b>			-	19.05								1.30
<b>DBC C2060 H</b>	38.10	12.70	11.91	-	14.55	16.55	5.96	3.2	18.1	4,100	660	1.51
<b>DBC C2062 H</b>			-	22.23								2.19
<b>DBC C2080 H</b>	50.80	15.88	15.88	-	18.30	20.90	7.94	4.0	24.1	7,000	1,150	2.66
<b>DBC C2082 H</b>			-	28.58								3.68
<b>DBC C2100 H</b>	63.50	19.05	19.05	-	21.80	24.50	9.54	4.8	30.1	11,000	1,900	3.99
<b>DBC C2102 H</b>			-	39.67								6.30
<b>DBC C2120 H</b>	76.20	25.40	22.23	-	26.95	30.55	11.11	5.6	36.2	15,400	2,600	5.35
<b>DBC C2122 H</b>			-	44.45								8.60
<b>DBC C2160 H</b>	101.60	31.75	28.58	-	33.65	38.45	14.29	7.2	48.2	26,300	4,300	9.42
<b>DBC C2162 H</b>			-	57.15								11.79

\* C2040~: standard S-Roller Type \* C2040~: standard S-Roller Type



# Double Pitch Attachment Chain

## 더블피치 어태치먼트 체인

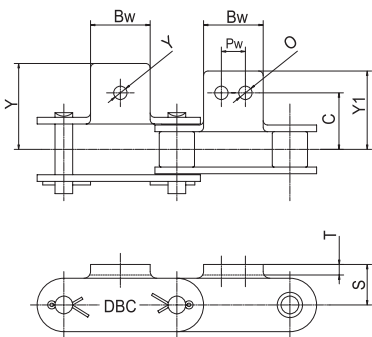

A-1, A-2 Att.\*

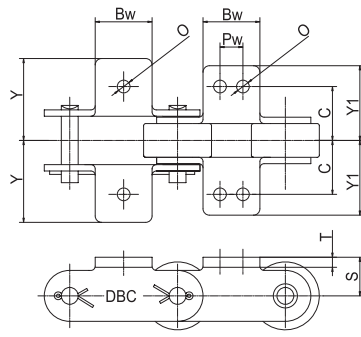

K-1, K-2 Att.

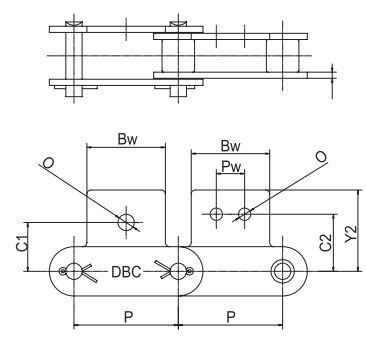

SA-1, SA-2 Att.

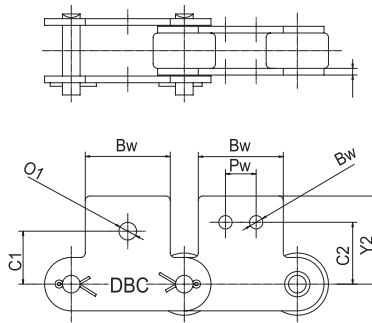

SK-1, SK-2 Att.

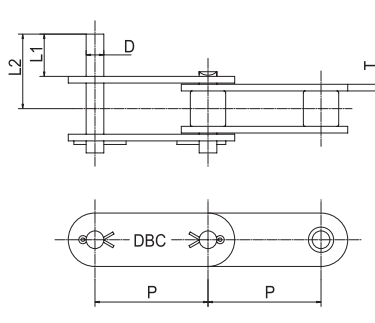

D-1 Att.

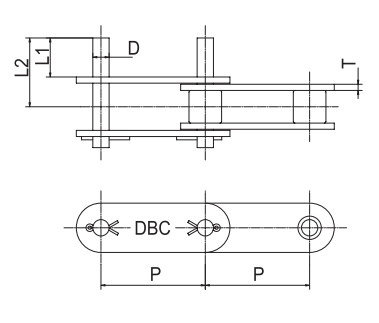

D-3 Att.

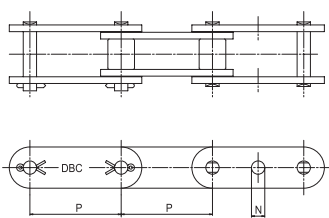

G-Att. (S-Roller Type)

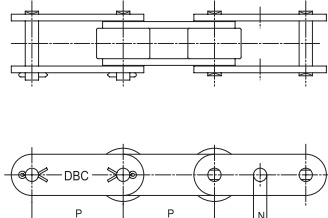

G-Att. (R-Roller Type)

\* Att.=Attachment



## Double Pitch Attachment Chain

### 더블피치 어태치먼트 체인

DONG BO Basic Chain No.	Attachment Dimensions									
	P	T	C	C1	C2	Bw	Pw	O	O1	S
	unit : mm									
<b>DBC C2040</b>	25.40	1.5	12.70	11.10	13.60	19.10	9.50	3.60	5.20	9.10
<b>DBC C2042</b>										
<b>DBC C2050</b>	31.75	2.0	15.90	14.30	15.90	23.80	11.90	5.20	6.80	11.10
<b>DBC C2052</b>										
<b>DBC C2060H</b>	38.10	3.2	21.45	17.50	19.10	28.60	14.30	5.20	8.70	14.70
<b>DBC C2062H</b>										
<b>DBC C2080H</b>	50.80	4.0	27.80	22.20	25.40	38.10	19.10	6.80	10.30	19.10
<b>DBC C2082H</b>										
<b>DBC C2100H</b>	63.50	4.8	33.35	28.60	31.80	47.60	23.80	8.70	14.30	23.40
<b>DBC C2102H</b>										
<b>DBC C2120H</b>	76.20	5.6	39.70	33.30	37.30	57.20	28.60	14.00	16.00	27.80
<b>DBC C2122H</b>										
<b>DBC C2160H</b>	101.60	7.2	52.39	44.45	50.80	76.20	38.10	16.10	19.50	36.50
<b>DBC C2162H</b>										

DONG BO Basic Chain No.	Attachment Dimensions							Additional Weight per Attachment(kg)			
	Y	Y1	Y2	D	L1	L2	N	A&SA	K&SK	D-1	D-3
	unit : mm										
<b>DBC C2040</b>	19.30	17.60	19.80	3.97	9.5	16.85	4.07	0.003	0.006	0.001	0.002
<b>DBC C2042</b>											
<b>DBC C2050</b>	24.20	22.00	24.60	5.09	11.9	21.15	5.20	0.006	0.012	0.002	0.004
<b>DBC C2052</b>											
<b>DBC C2060H</b>	31.50	28.20	30.60	5.96	14.3	27.50	6.07	0.017	0.034	0.003	0.006
<b>DBC C2062H</b>											
<b>DBC C2080H</b>	40.70	36.60	40.50	7.94	19.1	35.58	8.10	0.037	0.074	0.007	0.014
<b>DBC C2082H</b>											
<b>DBC C2100H</b>	49.90	44.90	50.40	9.54	23.8	43.58	9.67	0.067	0.134	0.012	0.024
<b>DBC C2102H</b>											
<b>DBC C2120H</b>	60.70	54.40	59.90	-	-	-	11.24	0.100	0.200	-	-
<b>DBC C2122H</b>											
<b>DBC C2160H</b>	79.00	71.00	78.60	-	-	-	14.47	0.240	0.490	-	-
<b>DBC C2162H</b>											