

## Bearing Roller Chain 베어링 내장형 체인

This chain contains ball bearings inside the rollers.  
Low rotating frictional force of the roller allows minimal operational loss and high allowable load compared to other rollers.

- Dimensions of the assembled chain and attachments are identical to general conveyor chains.
- General conveyor chain sprockets are used.
- Coefficient of rotating friction  $f : 0.035 \sim 0.05$

- 로울러에 볼베어링을 넣거나 로울러와 부쉬 사이에 니이들을 넣은 형식의 체인입니다.  
로울러의 회전마찰이 적어 체인의 구동손실이 적으며, 일반 로울러에 비하여 로울러의 허용부하가 높습니다.
- 체인 본체 및 어태치먼트의 치수는 범용 컨베이어 체인과 동일합니다.
  - 스프라켓도 범용 컨베이어 체인용 스프라켓과 동일하게 사용합니다.
  - 회전 마찰계수  $f : 0.035 \sim 0.05$

### Ball bearing chain (볼 베어링 체인)

Type-BR

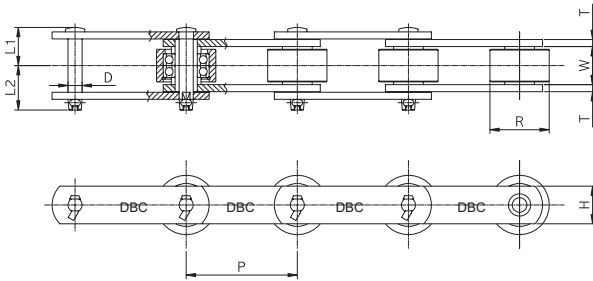

Type-BF

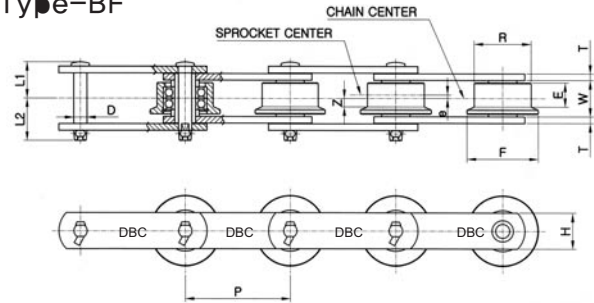

unit:mm

DONG BO Chain No.		Pitch	Roller Diameter	F-Roller Dimensions					Inner Width	Plate		Pin			max. Allowable Load of Roller (kg/each)		Avg. Breaking Load(kgf)		Weight				
Basic Chain	Type of Roller			P	R	R	F	E		e	Z	T	H	D	L1	L2	R-Roller	F-Roller	Standard Series	Heavy Series	R-Roller	F-Roller	
<b>DBC 05100</b>	BR·BF	100	40	40	50	14	2.5	4.5	22	4.5	32	11.1	24.6	29.6	310	200	3,000	7,100	5.0	5.2			
	BR·BF	150																			4.4	4.2	
<b>DBC 08150</b>	BR·BF	150	44.5	44.5	55	20	3	7	27	6.3	28.6	11.1	30.7	35.7	420	270	8,000	11,500	5.5	5.8			
<b>DBC 10100</b>	BR·BF	100	50.8	50.8	65	20	3	7	30	6.3	38.1	14.3	32.7	39.2	560(790)	350	11,500	23,000	9.8	10.3			
	<b>DBC 10125</b>	BR·BF																			125	8.7	8.9
	<b>DBC 10150</b>	BR·BF																			150	7.9	8.1
<b>DBC 6205</b>	BR·BF	152.4	57.2	57.2	70	25	3.5	9	37.1	7.9	44.5	15.9	40	46.5	850(1,200)	560	19,000	28,500	12.1	12.4			
<b>DBC 12200</b>	BR·BF	200	65	65	80	24	4	8	37.1	7.9	44.5	15.9	40	46.5	850(1,200)	560	19,000	28,500	11.4	11.9			
	<b>DBC 12250</b>	BR·BF																			250	10.3	10.6
<b>DBC 212</b>	BR·BF	152.4	69.9	69.9	85	25	4	8.5	37.1	9.5	50.8	19.05	44.2	52.7	1,440(2,000)	1000	25,000	39,500	17.1	18			
<b>DBC 17200</b>	BR·BF	200	80	80	100	34	5	12	51.4	9.5	50.8	19.05	51.5	60	1,440(2,000)	1000	25,000	39,500	18.8	19.8			
	<b>DBC 17250</b>	BR·BF																			250	16.5	17.3
	<b>DBC 17300</b>	BR·BF																			300	15.0	15.7
<b>DBC 26200</b>	BR·BF	200	100	100	125	38	6	13	57.2	9.5	63.5	22.2	55.2	62.7	2,000(2,800)	1400	32,000	53,000	29	31			
	<b>DBC 26250</b>	BR·BF																			250	25.3	26.2
	<b>DBC 26300</b>	BR·BF																			300	22.3	23.6
	<b>DBC 26450</b>	BR·BF																			450	18.0	18.9
<b>DBC 36250</b>	BR·BF	250	125	125	150	49	8	16.5	77	12.7	90	35	77	84	2,800(3,900)	1900	48,500	69,500	42.7	45.8			
	<b>DBC 36300</b>	BR·BF																			300	39.0	40.1
	<b>DBC 36450</b>	BR·BF																			450	30.7	31.9

주) ( )내 치수는 1개의 로울러에 베어링 2개 내장시 적용.  
Note) Numbers within ( ) are used when two bearings are contained in one roller.

# Bearing Roller Chain

## 베어링 내장형 체인

### Needle bearing chain 니이들 베어링 체인

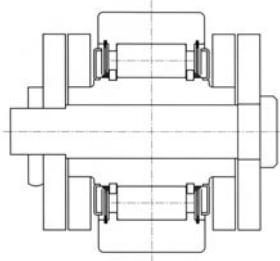

Section of Roller 로울러의 단면

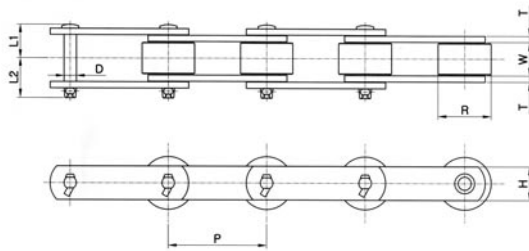

Type-NBR

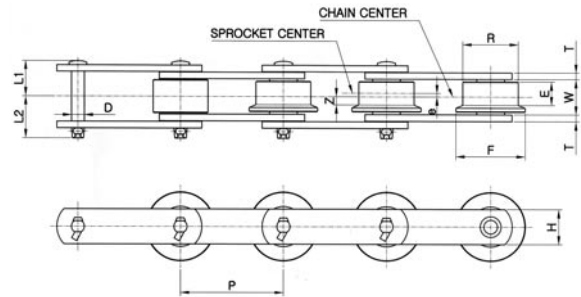

Type-NBF

unit:mm

DONG BO Chain No.		Pitch	Roller Dia meter			F-Roller Dimensions					Inner Width	Plate		Pin		max. Allowable Load of Roller (kg/each)		Avg. Breaking Load(kgf)		Weight		
Basic Chain	Type of Roller		P	R	E	R	F	E	e	Z		T	H	D	L1	L2	R-Roller	F-Roller	Standard Series	Heavy Series	R-Roller	F-Roller
<b>DBC 03075</b>	NBR-NBF	75	31.8	15.5		31.8	42	12	1.8	4.3	16.1	3.2	22	7.9	17.5	19.5	200	130	3.000	7.100	2.7	2.8
<b>DBC03100</b>	NBR-NBF	100																			2.3	2.4
<b>DBC05100</b>	NBR-NBF	100	40	19		40	50	14	2.5	4.5	22	4.5	32	11.1	24.6	29.6	310	200	7.000	14.500	5.0	5.2
<b>DBC05150</b>	NBR-NBF	150																			4.1	4.2
<b>DBC450</b>	NBR-NBF	101.6	44.5	23		44.5	55	20	3	7	27	6.3	28.6	11.1	30.7	35.7	420	270	8.000	14.500	6.8	7.2
<b>DBC08150</b>	NBR-NBF	150	44.5	23		44.5	55	20	3	7	27	6.3	28.6	11.1	30.7	35.7	420	270	8.000	14.500	5.5	5.6
<b>DBC10100</b>	NBR-NBF	100																			9.8	10.3
<b>DBC10125</b>	NBR-NBF	125	50.8	27		50.8	65	20	3	7	30	6.3	31.8	14.3	32.7	39.2	560	350	11.500	23.000	8.7	8.9
<b>DBC10150</b>	NBR-NBF	150																			7.9	8.1
<b>DBC6205</b>	NBR-NBF	152.4	57.2	32		57.2	70	25	3.5	9	37.1	7.9	44.5	15.9	40	46.5	850	560	19.000	28.500	12.1	12.4
<b>DBC12200</b>	NBR-NBF	200																			11.4	11.9
<b>DBC12250</b>	NBR-NBF	250	65	32		65	80	24	4	8	37.1	7.9	44.5	15.9	40	46.5	850	560	19.000	28.500	10.3	10.6
<b>DBC212</b>	NBR-NBF	152.4	69.9	32.5		69.9	85	25	4	8.5	37.1	9.5	50.8	19.05	44.2	52.7	1.440	1.000	25.000	39.500	17.1	18
<b>DBC17200</b>	NBR-NBF	200																			18.8	19.8
<b>DBC17250</b>	NBR-NBF	250	80	44		80	100	34	5	12	51.4	9.5	50.8	19.05	51.5	60	1.440	1.000	25.000	39.500	16.5	17.3
<b>DBC17300</b>	NBR-NBF	300																			15.0	15.7
<b>DBC26200</b>	NBR-NBF	200																			29.0	31.0
<b>DBC26250</b>	NBR-NBF	250																			25.3	26.2
<b>DBC26300</b>	NBR-NBF	300	100	50		100	125	38	6	13	57.2	9.5	63.5	22.2	55.2	62.7	2.000	1.400	32.000	53.000	22.2	23.6
<b>DBC26450</b>	NBR-NBF	450																			18.0	18.9
<b>DBC36300</b>	NBR-NBF	300																			42.7	45.8
<b>DBC36450</b>	NBR-NBF	450	125	56		125	150	49	8	16.5	77	12.7	90	35	77	84	2.800	1.900	48.500	69.500	39.0	40.1
<b>DBC36600</b>	NBR-NBF	600																			30.7	31.9